

# Integrated Pump Solution

## 0.75 kW – 22 kW

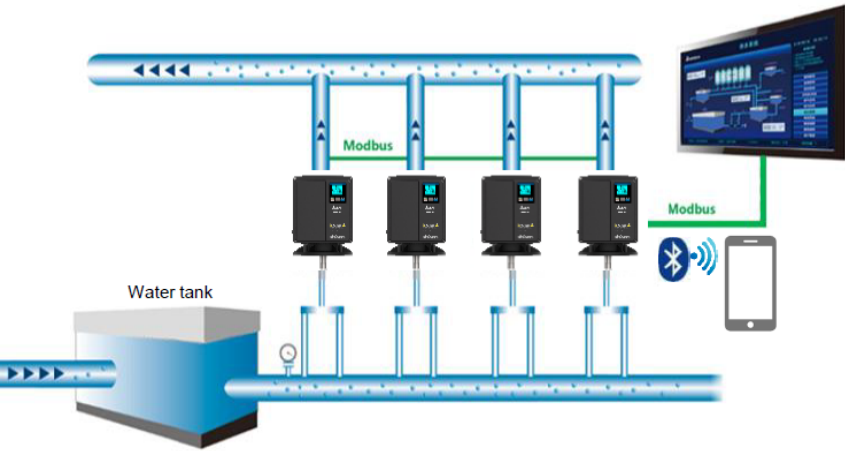

- Motor mounted (IES2 motor)
- Private label possible
- Intelligent Pump Function
  - Multi-pump control
  - Multi-master function
  - Dry Run/ Leakage Detection
- SynRM / IM / PM supported
- IP55 enclosure, fan-free design
- Integrated PLC and real time clock
- Build in EMI filter
- APP ( Bluetooth ) optionally available for pump application

Use connector to assemble

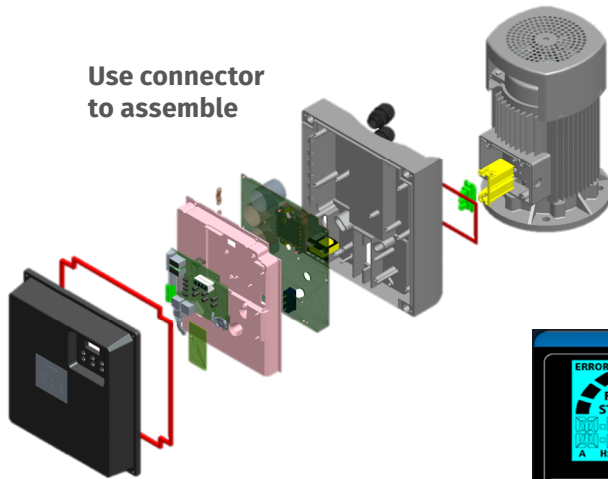

**FAST AND EASY INSTALLATION**

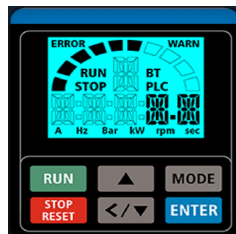

- Clear keypad for
- Mode & status
  - Pressure value
  - Parameter



**CUSTOM DESIGN**

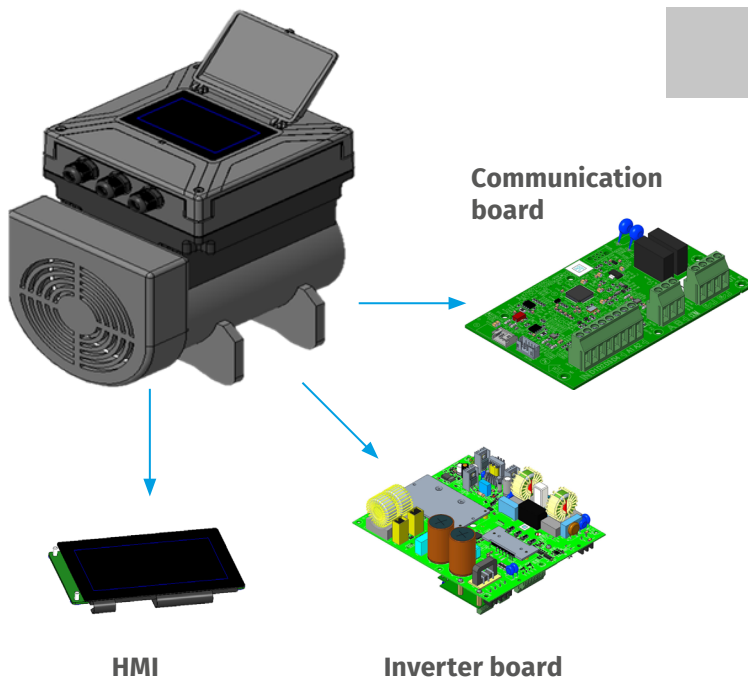

- Custom design
- Short development time
- Private label
- Integrated Solution only
- Intelligent Pump Function

**1φ 230V, 0.2 ~ 2.2kW**  
**3φ 400V, 0.2 ~ 5kW**

# Pump Solution Overview

## Standard Pump VFD

### Performance

<b>C2000+</b>	Adaptability, Connectivity, Enhancement High performance, on board PLC, full power range/optional card		<b>0.75~630kW</b> <b>200V-400V-690V series</b>		<b>PM</b> <b>IM</b>	<b>SynRM</b>	<b>150%</b> <b>overload</b>
<b>CP2000</b>	Energy-saving HVAC systems for pump and fan applications. 120% light load capability, on board PLC, full power range/optional card		<b>0.75~630kW</b> <b>200V-400V-690V series</b>		<b>PM</b> <b>IM</b>	<b>SynRM</b>	<b>120%</b> <b>overload</b>
<b>CFP2000</b>	HVAC, fans & pumps, water treatment, IP55 enclosure, On board PLC Standard BACnet on board, complete range optional card		<b>0.75~90kW</b> <b>200V-400V-690V series</b>		<b>PM</b> <b>IM</b>	<b>SynRM</b>	<b>120%</b> <b>overload</b>
<b>ME300</b>	Simple fans & pump applications, small power range		<b>0.1~7.5kW</b> <b>200V-400V series</b>		<b>PM</b> <b>IM</b>		<b>120%</b> <b>overload</b>

### Many possibilities, solution for any application

- Intelligent Pump Control
- Multi-Pump Control Mode
- Constant Pressure Control
- Auto Detection of Water Suspension
- Smart PID for Leakage Detection
- Fire Mode
- Flying Start

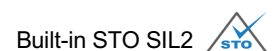

[www.industrialautomationdelta-emea.com](http://www.industrialautomationdelta-emea.com)  
[www.deltaww.com](http://www.deltaww.com)

[Sales.IA.DACH@deltaww.com](mailto:Sales.IA.DACH@deltaww.com)

